



# ASSEMBLY & USER GUIDE



ALWAYS WEAR SAFETY CLOTHING IN CONJUNCTION WITH HAND, EYE, HEARING AND FOOT PROTECTION TO HSE/EN SPECIFICATIONS



# Read and understand these safety instructions before use

## Get the right safety equipment - don't take chances

### Head, eye and hearing protection

Face protection visor to EN1731

or Safety Glasses/Goggles to glasses to EN166

Hearing protection to EN 352-1: 2002

Helmet to EN 397

### Body and Limb protection

Chainsaw protective jacket to EN381-11

Cut protection trousers type A minimum to EN381-5

### Hand protection

Chainsaw Gloves to EN381-7

### Foot protection

Steel Toecap Boots to EN EN345-2

distinctively marked as suitable for chainsaw use, to EN381-3[1]



Use **ALL** safety equipment as recommended by your chainsaw manufacturer. Don't take chances.

**DO NOT RUSH** - take your time and work at a reasonable pace



**ENSURE ALL THE FIXINGS ARE TIGHT** - check the tightness of the bolts and also chainsaw vice before work and regularly whilst operating as fixings can become loose due to the vibration of the chainsaw



**CHECK CHAINBAR GUARD DOES NOT TOUCH THE CHAIN** - DO NOT continue to use the Logmaster if the chain guard is touching the chain. Adjust immediately.



**ENSURE LOGMASTER IS STABLE** - DO NOT use if the Logmaster is unsteady due to uneven or very soft ground.

**IF IN DOUBT, DO NOT USE** - if you are not sure about the chainsaw or any aspects of using your chainsaw with the Logmaster, get expert advice - don't take chances.

# Read and understand these safety instructions before use

Chainsaws are dangerous - don't take risks.  
YOUR safety is YOUR responsibility.

This safety information must be read before using a chainsaw with the Logmaster Saw Horse.

- ALWAYS** Risk assess your job and be safe. Check the wood pile, and surroundings ensuring a clear escape route.
- ALWAYS** Read and follow the chainsaw manufacturer's operator guide.
- ALWAYS** Wear full chainsaw safety clothing including proper gauntlets, helmet, ear protectors, safety chainsaw boots, and safety chainsaw overalls.
- ALWAYS** Make sure that the Logmaster bench is level and secure.
- ALWAYS** Make sure that other people stand well clear of the cutting operation.
- ALWAYS** Hold the wood down with your left hand **VERY FIRMLY** the chain will rotate towards the chainsaw body and will want to snatch the wood upwards.
- NEVER** Let your hand be closer than 30cm from the chainsaw cutting bar.
- NEVER** Let the chain bar vice/clamp get loose. Check regularly for tightness, making sure the bar remains in the correct position and CLEAR of the chain guard
- NEVER** Let the chain get blunt (see the chainsaw manufacturers handbook)
- NEVER** Cut multiple lengths of wood ONLY one piece at a time.
- NEVER** Cut wood which has ANY foreign bodies such as nails or screws.
- NEVER** Let the cut logs build up too high in front or to the side of the saw bench.
- NEVER** Work when feeling tired or try to rush the job.
- REGULARLY** Check ALL the Logmaster nuts and bolts ensuring they remain fully tightened.
- REGULARLY** Check that the chain guard nut is tight and is clear of the chain.



**ALWAYS WEAR SAFETY CLOTHING IN CONJUNCTION WITH HAND, EYE, HEARING AND FOOT PROTECTION TO HSE/EN SPECIFICATIONS**



# Assembly of your Logmaster

## Before you start - tools you will require:

17 mm or 5/8" Spanner (Pivot Clamp Bolt) and 13 mm or 1/2" Spanner (Chain Guard Nut).

### Fig 1. Height Adjustable Legs and Feet

Insert support feet into the hollow legs of the sawhorse and adjust height to suit. Tighten fixing bolts supplied and place logmaster on a flat surface. Push the red support pad onto the bottom of the telescopic leg as shown.

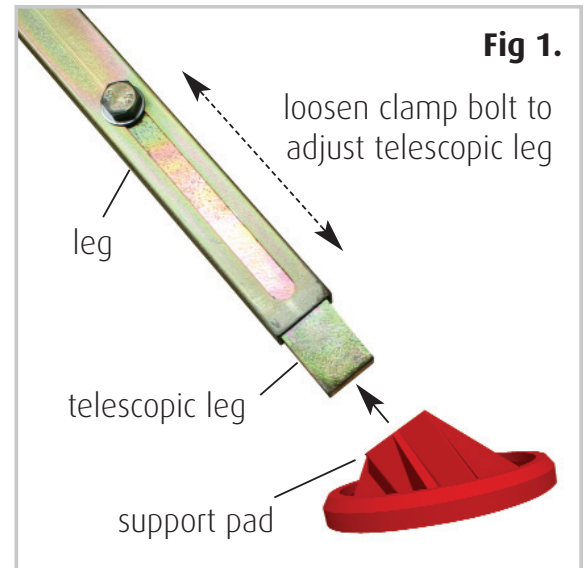

### Fig 2. Pivot Clamp Support and Measuring Rod

Insert the pivot clamp support (adjustable vertically) into the sawhorse table along with the measuring rod holder (adjustable horizontally) using the bolt and washer supplied. The vertical adjustment for the pivot clamp support is to accommodate different sized chain bars - the larger and longer the bar, the higher the pivot clamp should be placed. Adjust so that the tip of the chain bar extends beyond the table, so that it is cutting completely through the log. The measuring rod can be adjusted horizontally to allow each log to be cut to the desired length.

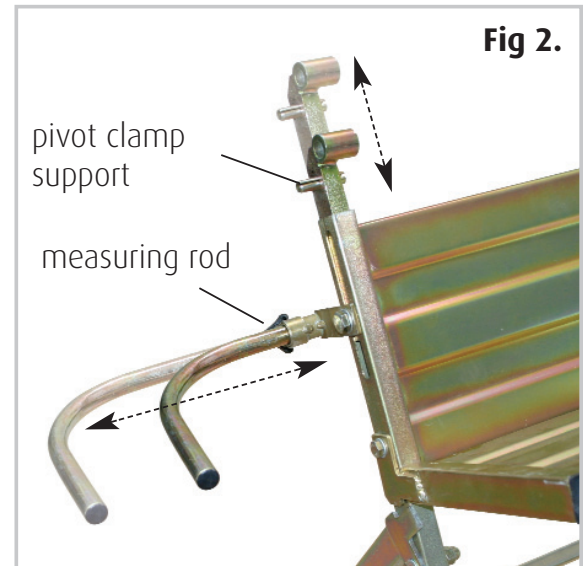

### Fig 3. Pivot Clamp

Insert the male rod on the pivot clamp into the female cylinder on the pivot support clamp and secure with the R clip.

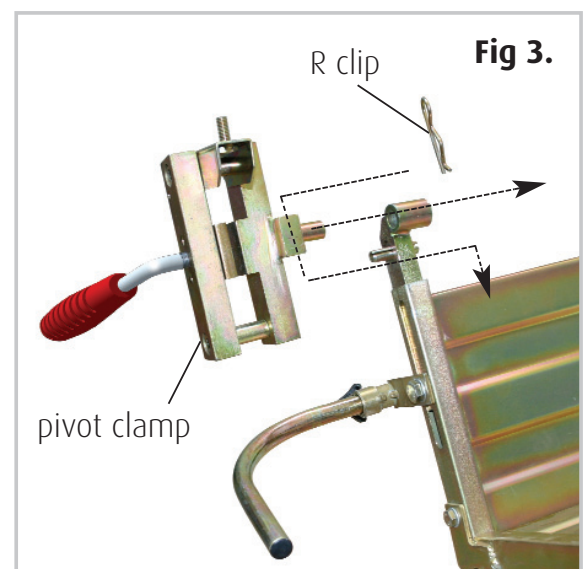

# Mounting the chainsaw

**Fig 4.** Carefully lower the chainsaw bar into position between the two solid blocks in the pivot clamp and ensure a minimum 2 cm gap between the body of the chainsaw and the clamp. Make sure that the bar is approx. 90° to the clamp and well clear of the chain before tightening the pivot clamp. Once tightened, test the arc of travel to make sure that the chain bar does **NOT** touch any part of the saw bench.

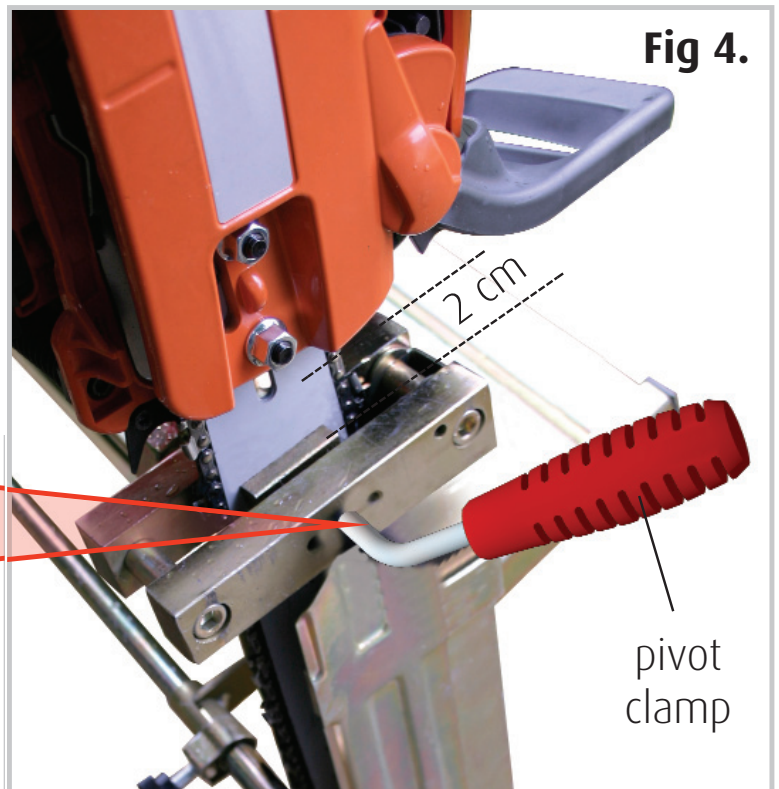

**The pivot clamp MUST be regularly checked for tightness!**

**Fig 5.** Mount the hole in the guard on the bolt protruding upwards from the clamp, loosely securing it with the nut and washers. Now slide the guard backwards or forwards as necessary to a position in which the guard is well clear of the chain and then tighten the nut. Recheck for clearance.

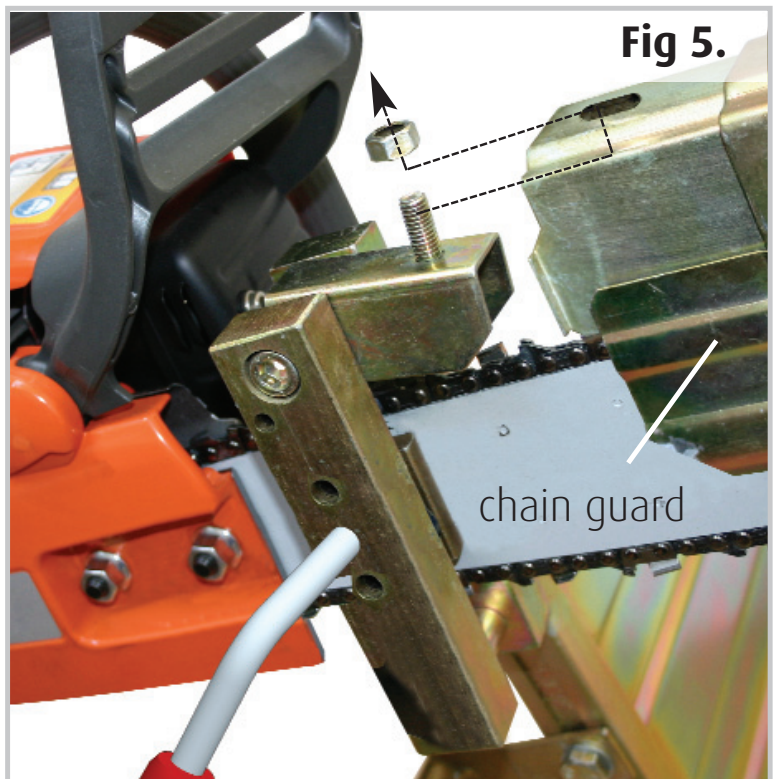

The instructions in this book must ALL be fully complied with to allow this partly completed machinery to be incorporated as a fully functional piece of machinery.

**The LOGMASTER is now ready for use**

# Using the Logmaster

- Place the wood on the log table pushing the end to the measuring rod. Hold the wood down firmly with your left hand, keeping your hand well clear of the cutting edge of the chainsaw, and arc the chainsaw down to cut.
- The log table on the Logmaster is designed for taking lengths to a maximum of 1.80 metres and a maximum diameter of 25 cm. The maximum permissible load on the Logmaster is 120 kg.
- The Logmaster chain guard is designed for chainsaws with a cutting bar not longer than 45 cm. A chainsaw with a cutting bar longer than 45 cm (which protrudes beyond the chain guard) is NOT recommended.
- The pivot clamp and guard must be detached when using the chainsaw separately from the Logmaster.
- The pivot clamp and support must be kept well lubricated.
- The Logmaster must be used on flat surfaces only.
- Ensure the nuts and bolts on the pivot clamp and guard are kept tight at all times.
- When using a chainsaw with the Logmaster it is essential that all safety codes and practices of the chainsaw manufacturer and Health and Safety Executive are fully followed.

# Declaration of incorporation



Portek Ltd.  
Bryn Hall,  
Knolton Bryn  
Overton-on-Dee  
Wrexham  
LL13 0LU  
stevemorris@portek.co.uk

## Declaration of Incorporation of Partly Completed Machinery

1. Manufacturer: Portek Ltd. Bryn Hall, Knolton Bryn, Overton-on-Dee, Wrexham, LL13 0LU
2. Authorised person who has compiled the relevant technical documentation : Stephen Morris: contact as above address
3. This declaration covers the "Logmaster" , a sawhorse having the ability to attach a cutting device rotatable relative to the saw horse. Designed specifically for use with chainsaws of bar length less than 45cm.
4. The Logmaster has been designed to meet with the Health and Safety standards as outlined in Annex 1 of the DIRECTIVE 2006/42/EC.
5. Any reasonable request by the national authorities by letter for relevant information will be fulfilled by email or letter.
6. The Logmaster, as a partly completed machine, must not be put into service until the complete machine has been declared as conforming with DIRECTIVE 2006/42/EC where appropriate.
7. Declaration made by Stephen Morris *S Morris* on 21/03/16 at Portek Ltd, address as above.

# Logmaster spares

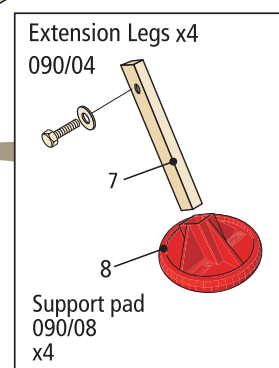
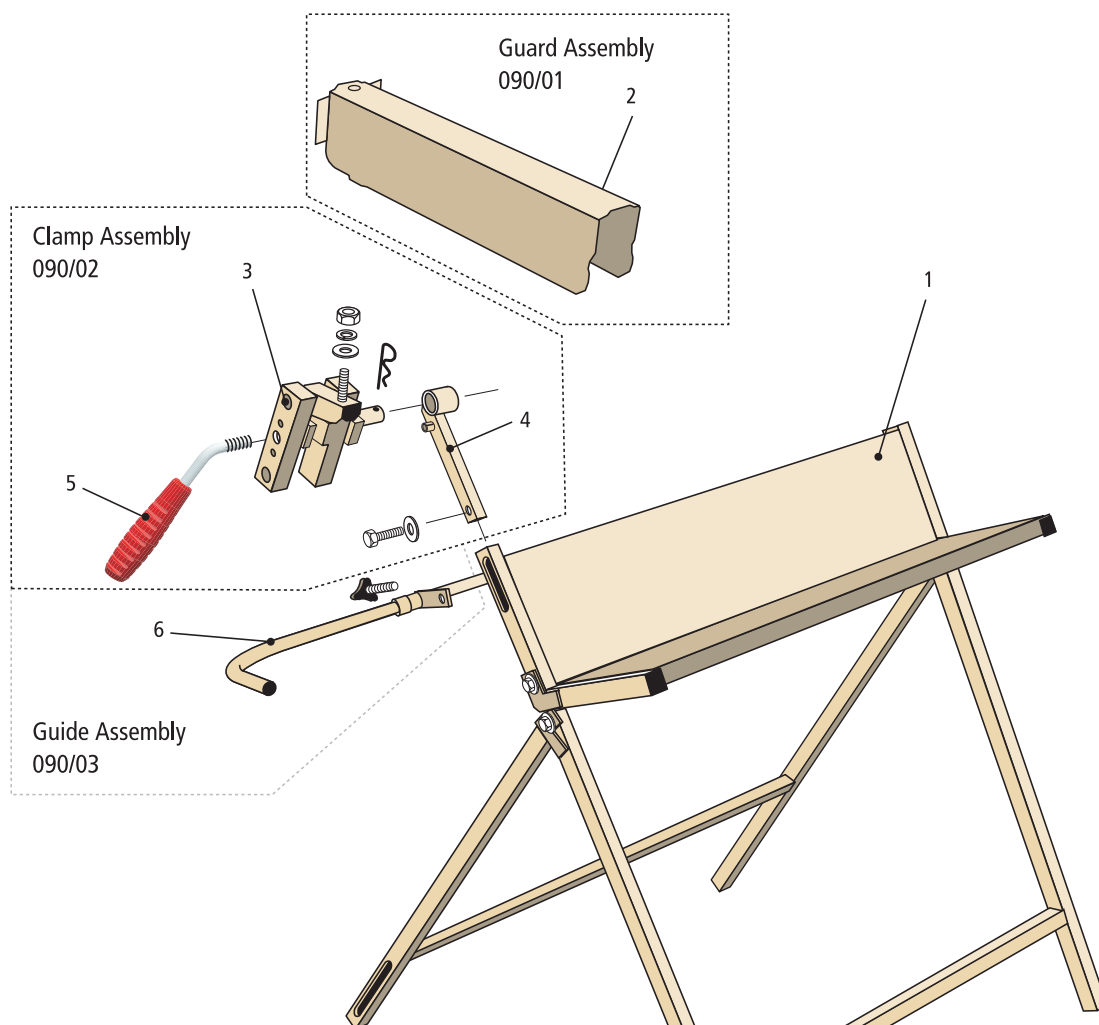

Item No.	Description	Part No.
2	Logmaster Guard	090/01
3,4,5	Logmaster Clamp and Pivot Arm	090/02
6	Logmaster Guide	090/03
7	Extension Legs (Set of 4)	090/04
4	Logmaster Pivot Arm	090/09
5	Handle for Logmaster Clamp	090/02H
8	Set of 4 Support Pads	090/08



Portek Ltd.  
 Bryn Hall, Knolton Bryn  
 Overton-on-Dee  
 Wrexham, LL13 0LF  
 Tel: 01234 889 454  
 Fax: 01234 889 464